

POCKET-WPK04-25W-H-TCP-EM

DESCRIPTION

The "Pocket" Small Wall Pack is a compact yet powerful outdoor lighting solution designed for reliability and efficiency. Featuring a 90-minute emergency battery backup, it ensures continued illumination during power outages. With a brightness of 2,750 lumens and 3CCT selectable color temperatures (3000K, 4000K, 5000K), it offers flexibility to suit various lighting needs. The built-in photocell enables automatic dusk-to-dawn operation for energy savings. ADA compliant and UL listed for wet locations, this sleek and durable wall pack is ideal for entryways, pathways, and commercial exteriors, providing both safety and style in a low-profile design.

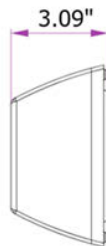
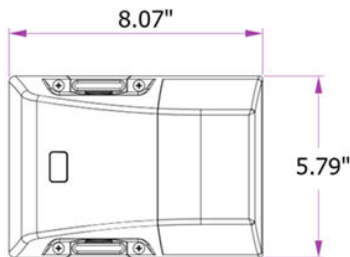

FEATURES

- Photocell included
- 90 Minutes battery back up
- 25 Watts LED with 3CCT
- UL listed
- 2750 Lumens

ELECTRICAL

Universal 120/277VAC 60Hz

WARRANTY

3 years manufacturer warranty, consult factory for more details.

- RateCurrent: 0.27A
- Input Voltage: AC100-277V
- 2750 Lumens
- Beam Angle: 90° X 140°
- Color Temperature: 4000K,5000K,5700K
- Luminous Efficacy: 110lm/W
- Color Rendering Index: Ra>80
- Turn-on Light Level: <20Lux
- Turn-off Light Level:>50Lux

CONSTRUCTION

ADC 12 / Brown lamp shell

PHOTOCELL

Internal photocell design which can automatically turn on at dusk and turn on at dawn.

LISTING

UL listed for wet location



Optical Properties

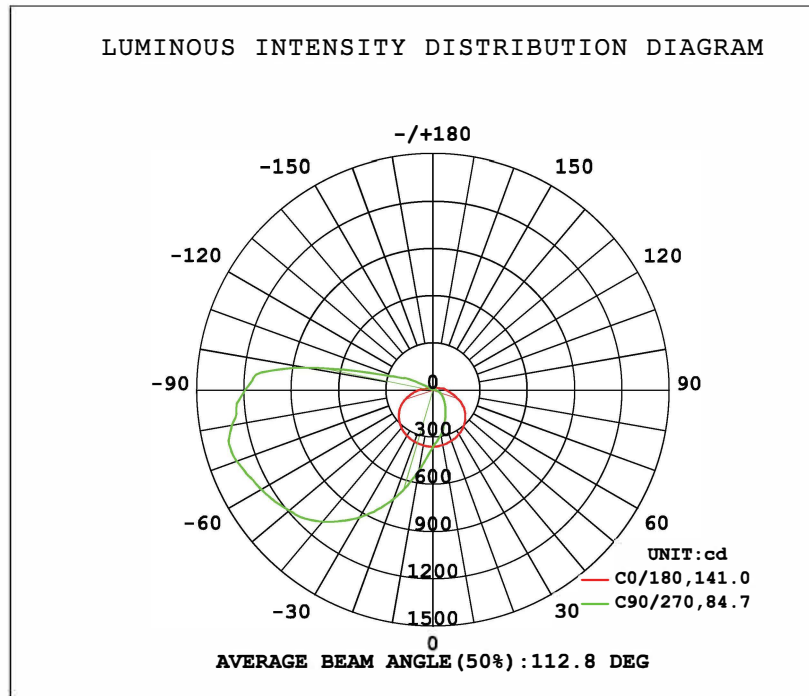

Applications

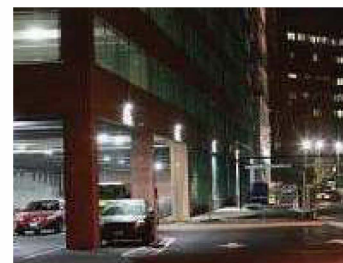
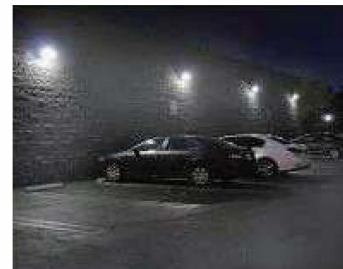
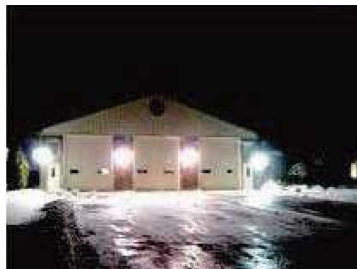

1 Disassemble the fixing screws of the lamp mounting plate with a screwdriver and remove the mounting plate;

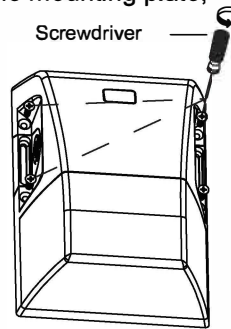

2 After knocking out the mounting holes with a hammer (at least 2 mounting holes and they should be in a symmetrical position), press the bracket on the wall with your hand and mark with the pen at the mounting screw position;

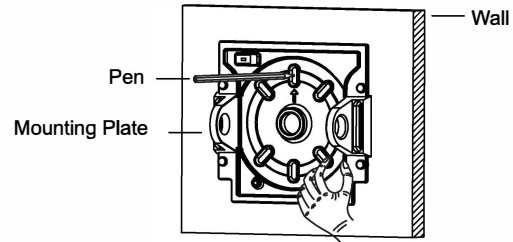

3 Use the electric drill to punch the hole at the mark position $\varnothing 8\text{mm}$, depth 40mm; and use a hammer to drive the plastic expansion tube into the hole;

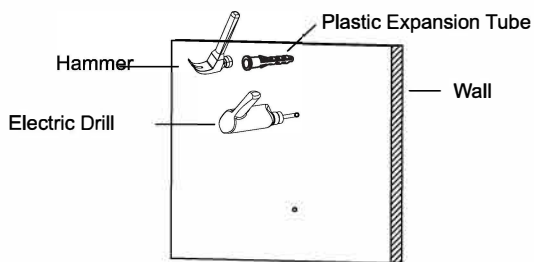

4 Fix the bracket with a screwdriver, and fix the fixture installation wire rope on the mounting plate, connect the cable as shown and do a good waterproof treatment;

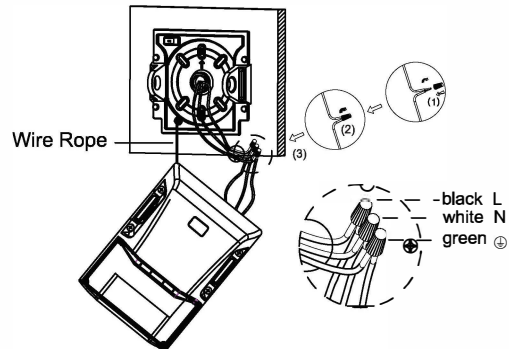

5 Put the lamp back on the mounting plate and secure the screws to complete the installation.

